

TOTAL INTEGRATED PANEL SYSTEMS | T I P S

T I P S technology provides both the structural and insulative advantage for pre-cast and tilt-up wall panel

BETTER PANEL

- 30-50% lighter panel.
- Structural advantage enabled by the continuous pyramidal truss wire and connected mesh design.
 - ✓ 2x2 11 ga. mesh equivalent to #3 rebar every 19".
 - ✓ 9 ga. diagonal @ 4" o.c. equivalent to #3 rebar every 12 ¾".
- Fully composite panel.
- Typically exceed energy envelope compliance requirements.
- Thermal Bridging minimized to less than 15% - Net R-Value @ 17+
- Carbon reductions both Embodied and Operational through measurable displacement of concrete, steel and improved R-value.

LESS EFFORT

- Panel system arrives pre-fabricated.
- Less material handling:
 - ✓ Reduce rebar up to 90%
 - ✓ Reduce concrete up to 50%
- Integrated welded wire diagonal truss omits installation of individual connectors.
- Opportunity for smaller crane and footing sizing.

MORE PROFIT

- Material savings: Concrete: 30% to 50% | Rebar 80% to 90% (design dependent).
 - ✓ Less material = Less Labor
- Reductions in roof structural diaphragm requirements due to lighter walls (region dependent).
- Crane size and timing efficiencies due to lighter panels.

TOTAL INTEGRATED PANEL SYSTEMS
375 East 400 North | Morgan Utah 84050
www.tipspanel.com

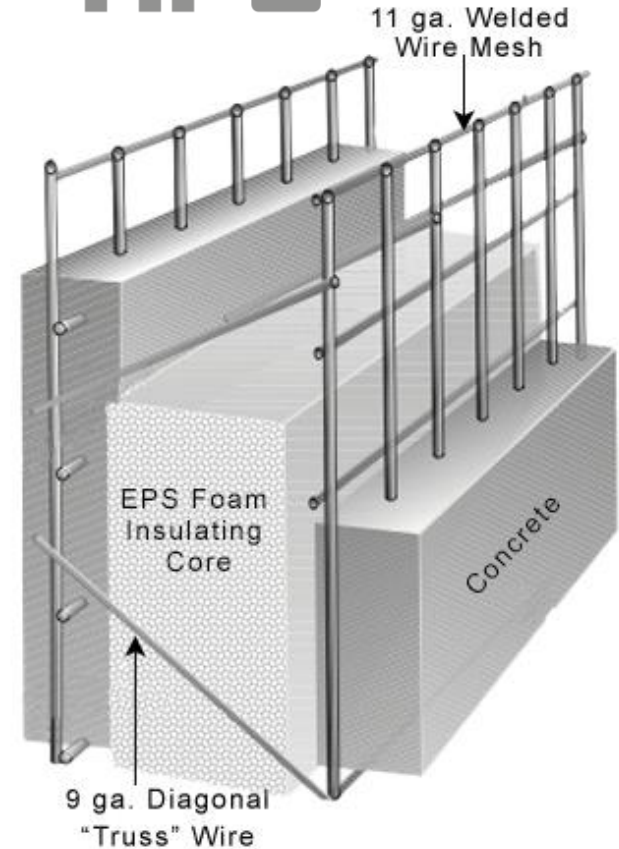
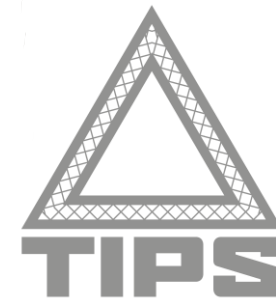

T I P S | The new advantage in tilt-up and pre-cast wall design and construction.